



MacDonalds Hotel, Leeds. Thanks to Eness Systems.

- One profile, lots of options
- Four circuit option for RGBA or RGBW mixing
- IP20 and IP68 rated
- Luxeon® LED
- Thermal feedback circuit
- Special options for up to 60°C ambient
- 25 micron marine grade anodised finish



CLV system is based on one simple extrusion shape with the ability to house lensed or unlensed LEDs. The CLVO lensed version shown here can be single colour, RGB or RGBA (or RGBW) in four circuit operation. The advantage of four circuit RGBA or RGBW fittings is their ability to mix a wider variety of 'white' shades with the addition of the fourth amber or white circuit. They are available for interior use (IP20) or resin filled for exterior or underwater operation (IP68).

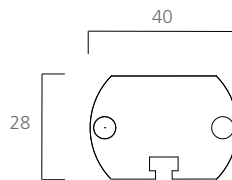
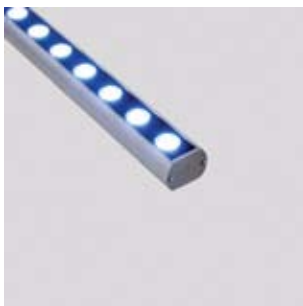

CLVO Module

Material	Aluminium alloy
Finish	Clear anodised
LED	350mA Luxeon®
Lens	8 x 25° oval beam
Cable Length	3 metres
Power Supply	See page 59
Options	Single colour, RGB 6, 10, 15 or 25° lenses

Module lengths - number of LEDs

Length	CLVO Single colour, RGB or 4 circuit RGBA/W
500	12
1000	24
1500	36

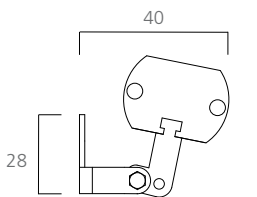

CLVO and CRE2824 Bracket

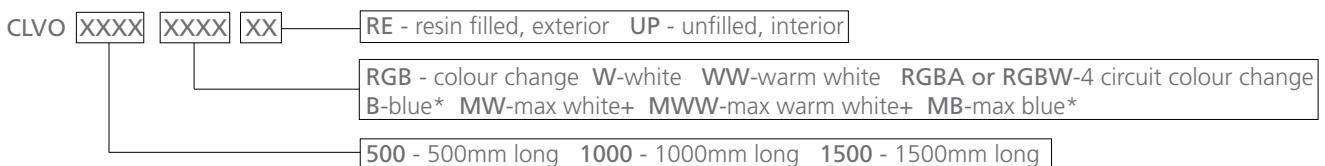

Example: **CLVO500RGBRE** is a CL Versatile RGB colour change module, 500mm long, resin filled for IP68 protection + max indicates 36 LEDs per 1500mm for single colour modules
 *Other colours are available to special order: Red, Green and Amber.

For drivers, connectors and control options see page 59.
 For typical wiring arrangements see page 61.